

# Handleiding / Anleitung / Manual

## ORION LINEAR LED

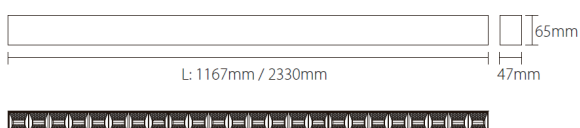
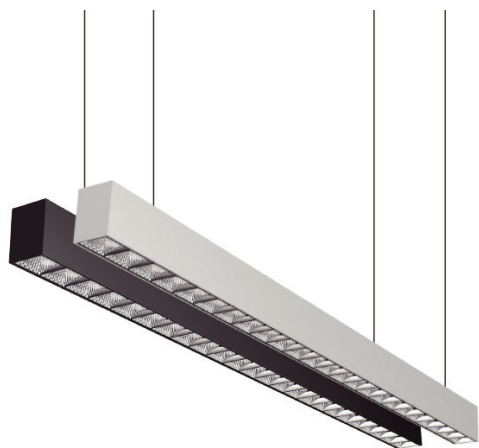

- NL** Lees voor gebruik eerst de installatie instructie en bewaar deze voor eventueel toekomstig gebruik.
- DE** Lesen Sie diese Anleitung vor Gebrauch aufmerksam durch und bewahren Sie diese für einen späteren Gebrauch gut auf.
- EN** Read this manual carefully and keep it for future use.

### Installatie / Installation / Installation

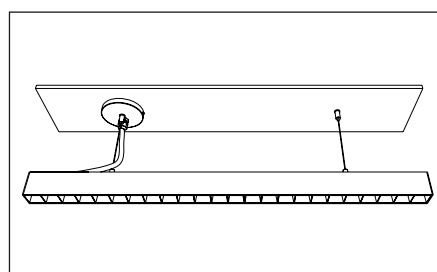
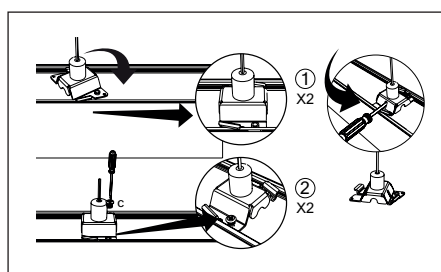
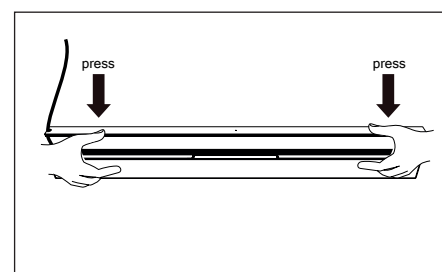
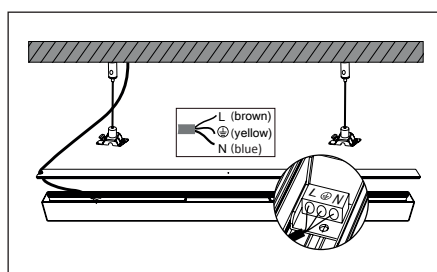
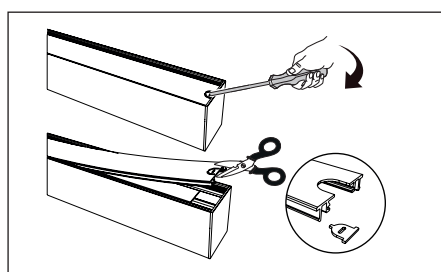
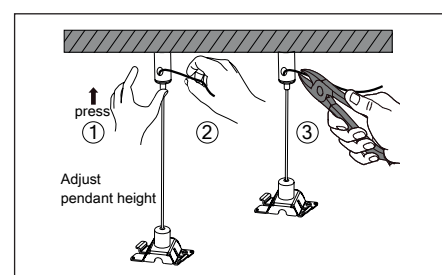
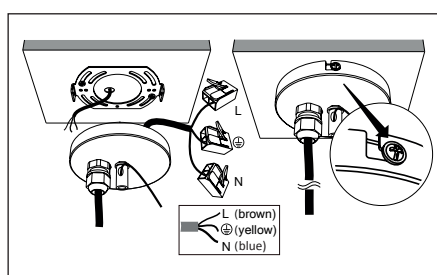
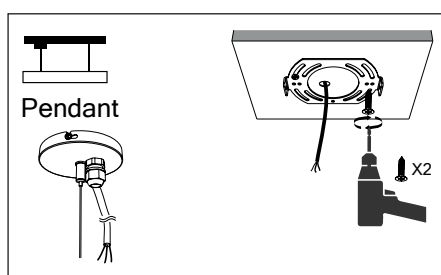

Verbindingsysteem / Verbindungssystem / Connection system

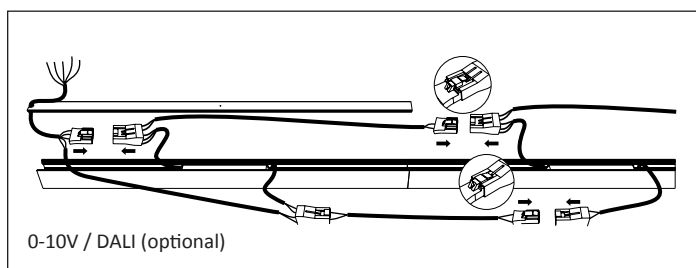
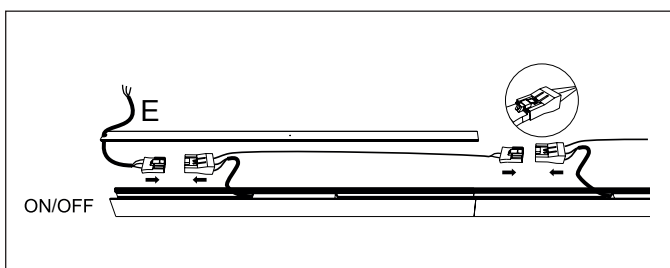
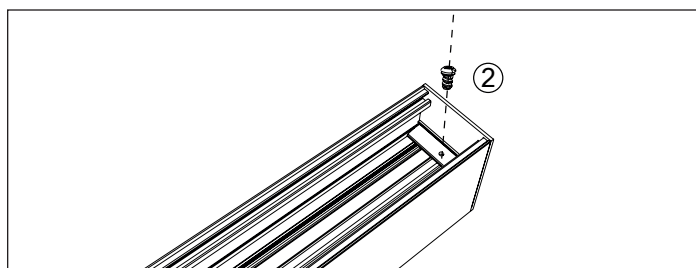
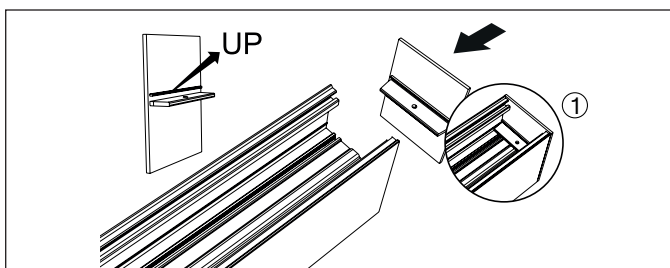
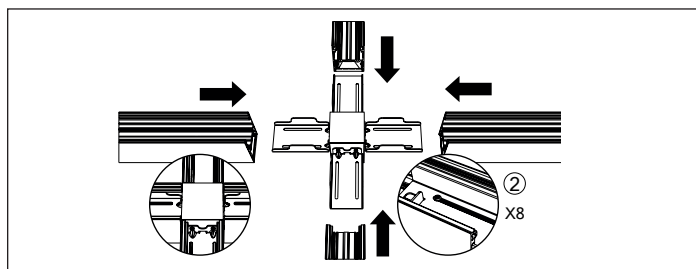
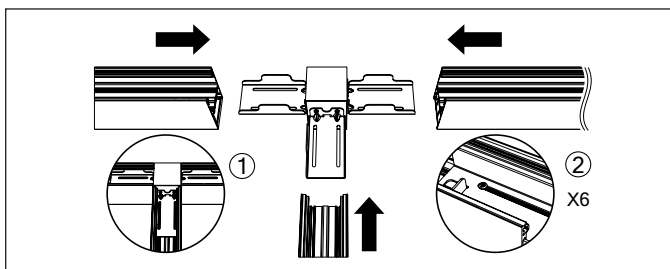
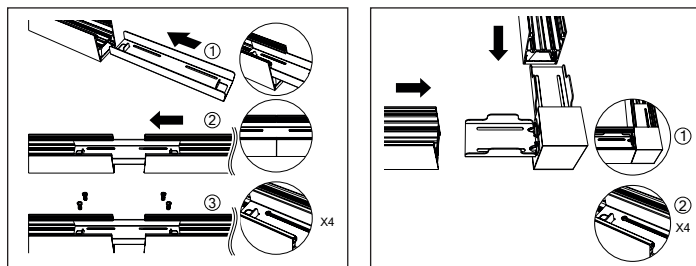
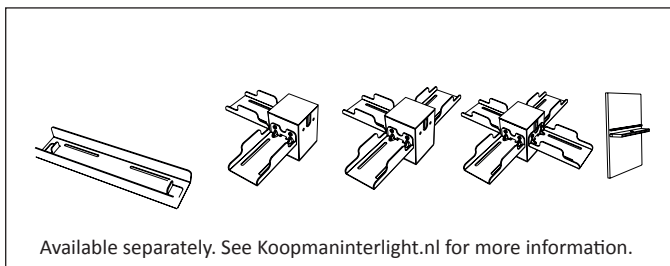

Algemene informatie / Allgemeine Informationen / General information

- NL**
- Pas op voor elektrische schokken.
  - Sluit de stroom af voor installatie en onderhoud.
  - Dit product mag alleen geïnstalleerd worden door een erkend installateur.
  - Het armatuur mag niet worden afgedekt met warmteïsoleerend materiaal.

- DE**
- Vorsicht vor Stromschlägen.
  - Schalten Sie die Stromzufuhr zur Installation und Wartung aus.
  - Dieses Produkt darf nur von einem anerkannten Installateur installiert werden.
  - Die Leuchte darf nicht abgedeckt werden mit wärmeisolierendes Material.

- EN**
- Beware of electric shocks.
  - Shut off the power for installation and maintenance.
  - This product may only be installed by a recognized installer.
  - The luminaire must not be covered with heat-insulating material.

